

NOTE: FOR MORE INFORMATION ON HIGHWAY CROSSING SIGNAL WITH GATE SEE AREMA C&S MANUAL PART 3.1.25 (FIGURE 3135.1)

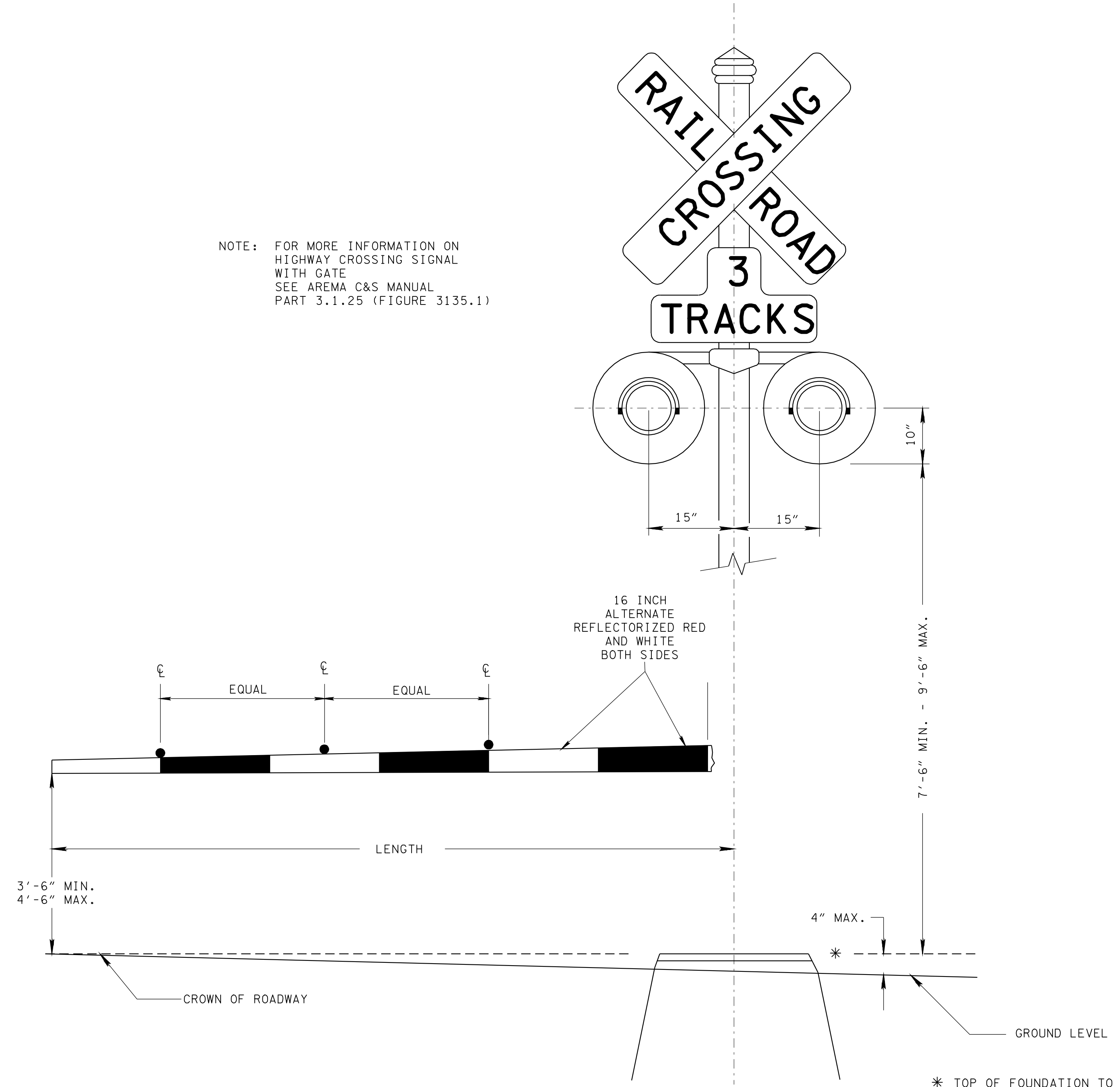

- GENERAL NOTES**
- (A) THE MEANING OF FLASHING-LIGHT SIGNALS AND GATES SHALL BE AS STATED IN THE "UNIFORM VEHICLE CODE" (SEE SECTIONS 11-701 AND 11-703 OF THE UVC), WHICH IS AVAILABLE FROM THE NATIONAL COMMITTEE ON UNIFORM TRAFFIC LAWS AND ORDINANCES (SEE PAGE I OF THE MUTCD FOR THE ADDRESS).
 - (B) LOCATION AND CLEARANCE DIMENSIONS FOR FLASHING-LIGHT SIGNALS AND GATES SHALL BE AS SHOWN IN FIGURE 8C-1 OF THE MUTCD.
 - (C) WHEN THERE IS A CURB, A HORIZONTAL OFFSET OF AT LEAST 2 FEET SHALL BE PROVIDED FROM THE FACE OF THE VERTICAL CURB TO THE CLOSEST PART OF THE SIGNAL OR GATE ARM IN ITS UPRIGHT POSITION. WHEN A CANTILEVERED-ARM FLASHING-LIGHT SIGNAL IS USED, THE VERTICAL CLEARANCE SHALL BE AT LEAST 17 FEET ABOVE THE CROWN OF THE HIGHWAY TO THE LOWEST POINT OF THE SIGNAL UNIT.
 - (D) WHEN THERE IS A SHOULDER, BUT NO CURB, A HORIZONTAL OFFSET OF AT LEAST 2 FEET FROM THE EDGE OF THE A PAVED OR SURFACED SHOULDER SHALL BE PROVIDED, WITH AN OFFSET OF AT LEAST 6 FEET FROM THE EDGE OF THE TRAVELED WAY. WHERE THERE IS NO CURB OR SHOULDER, THE MINIMUM HORIZONTAL OFFSET SHALL BE 6 FEET FROM THE EDGE OF THE TRAVELED WAY.

* TOP OF FOUNDATION TO BE AT THE SAME ELEVATION AS THE SURFACE OF THE TRAVELED WAY AND NO MORE THAN 4 INCHES ABOVE THE SURFACE OF THE GROUND (FOR CURBED SECTIONS SEE DRAWING T-RR-4).

RAILROAD-HIGHWAY CROSSING SIGNAL WITH GATE

CROSS-REFERENCE DRAWINGS NOTED ON THIS SHEET: T-RR-4

MINOR REVISION -- FHWA APPROVAL NOT REQUIRED.

STATE OF TENNESSEE
DEPARTMENT OF TRANSPORTATION

STANDARD DRAWING
FOR RAILROAD AND
HIGHWAY CROSSING
SIGNAL WITH GATE

T-RR-2