



**STATE OF TENNESSEE  
DEPARTMENT OF TRANSPORTATION**

**ROADWAY DESIGN DIVISION**  
SUITE 1300 JAMES K. POLK BUILDING  
505 DEADERICK STREET  
NASHVILLE, TENNESSEE 37243-3848  
(615) 741-2221

**JOHN C. SCHROER**  
COMMISSIONER

**BILL HASLAM**  
GOVERNOR

**INSTRUCTIONAL BULLETIN NO. 17-01**

**UPDATED FIGURE 2-22 – RURAL TYPE PROJECTS TYPICAL DRIVEWAY NOTATION AND  
FIGURE 2-23 – URBAN TYPE PROJECTS TYPICAL DRIVEWAY NOTATION**

**Effective immediately, *Figure 2-22 – Rural Type Projects Typical Driveway Notation and Figure 2-23 – Urban Type Projects Typical Driveway Notation* of the Roadway Design Guidelines have been updated.**

The updated figures are attached to this instructional bulletin.

  
Jennifer Lloyd, PE  
Civil Engineering Director  
Roadway Design Division

KJL: ARH: RBB: SSH

February 16, 2016

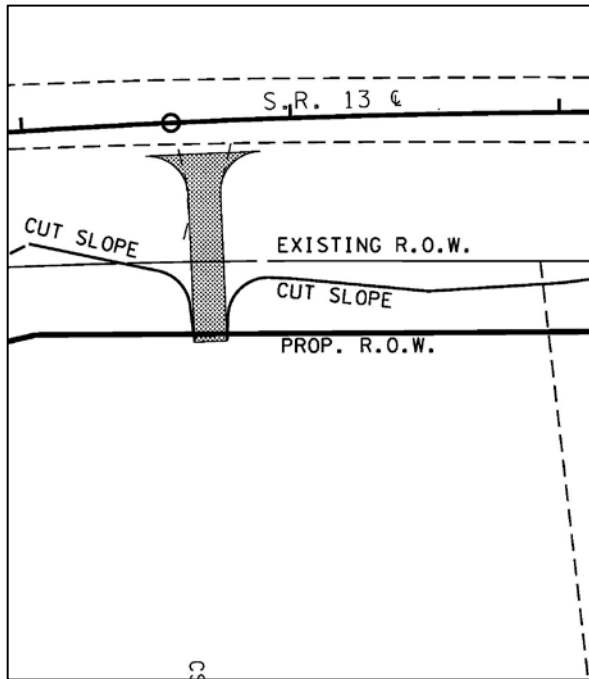

**PRESENT LAYOUT**

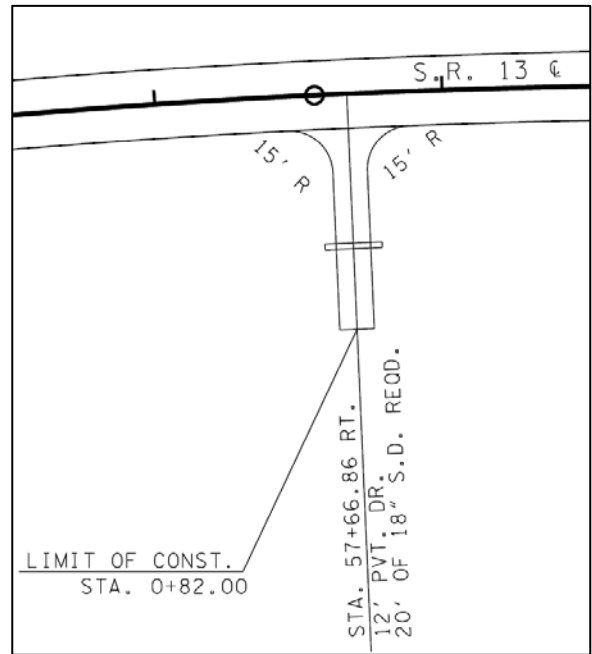

**PROPOSED LAYOUT**

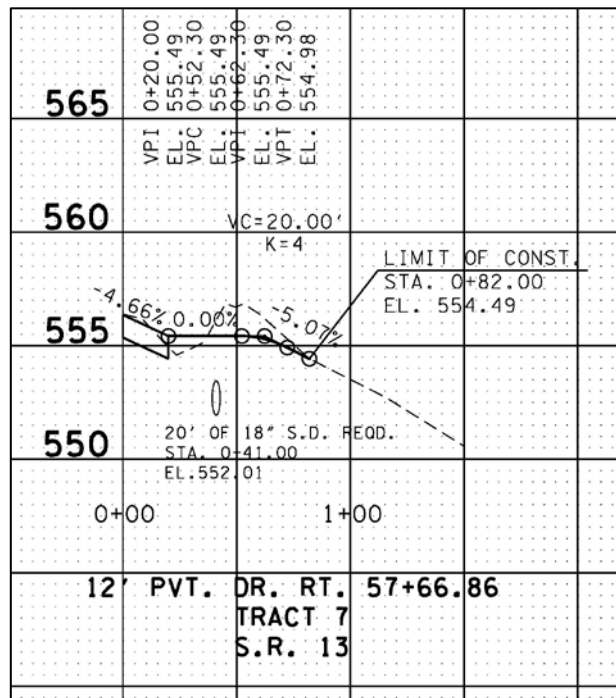

**PROFILE**

Figure 2-22  
Rural Type Projects Typical Driveway Notation

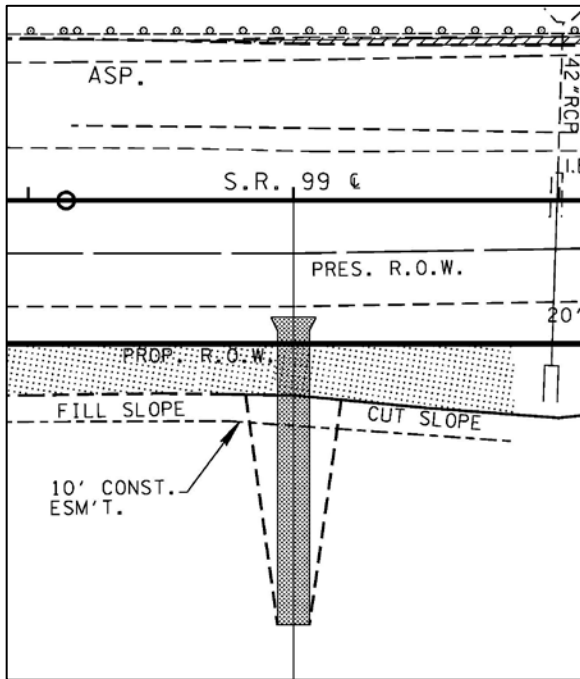

**PRESENT LAYOUT**

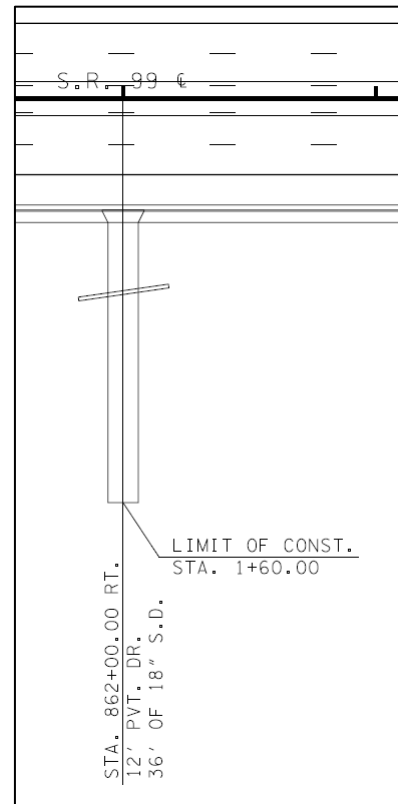

**PROPOSED LAYOUT**

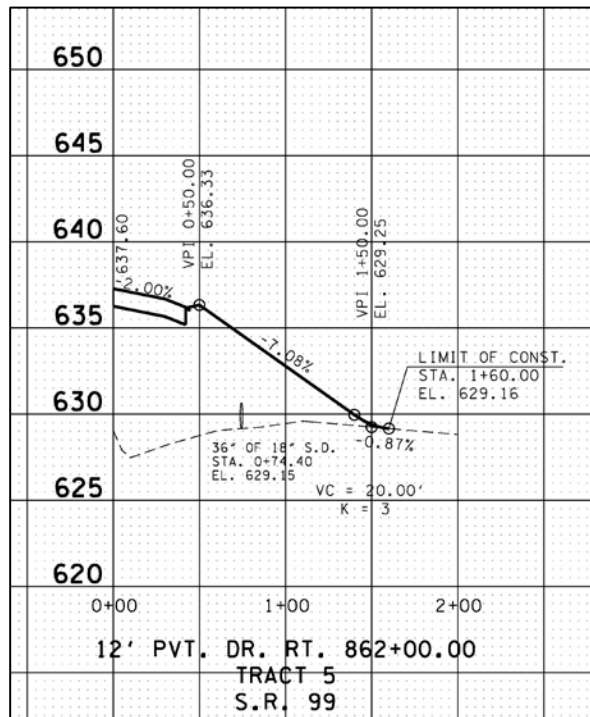

**PROFILE**

Figure 2-23  
Urban Type Projects Typical Driveway Notation